

CITY OF ALBUQUERQUE
NORTH DOMINGO BACA
POOL SIZE COMPARISON STUDY

HUITT-ZOLIARS
ADVANCED DESIGNSM
MARCH 18 2021

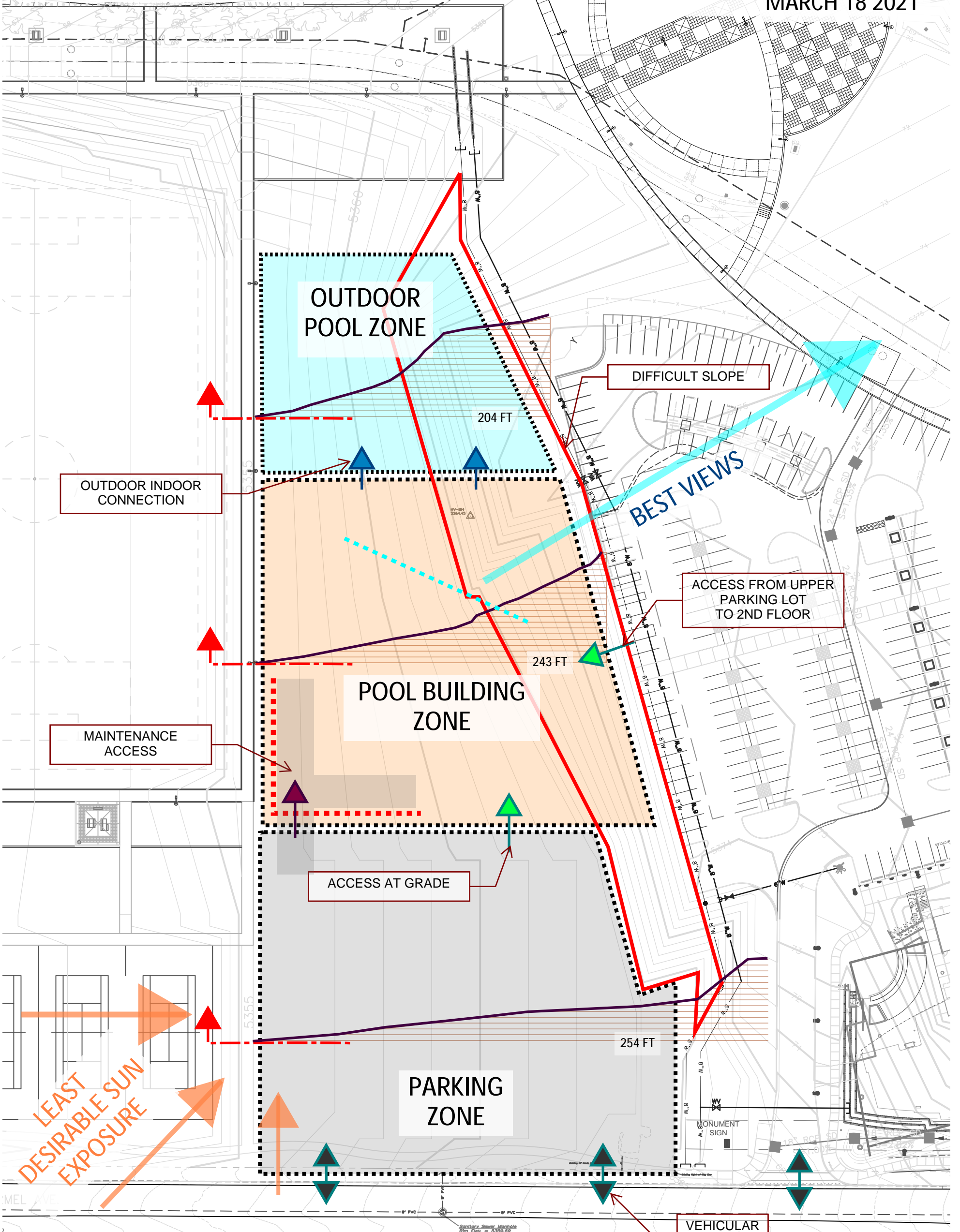

Existing Site



1/64" = 1-0"

CITY OF ALBUQUERQUE
NORTH DOMINGO BACA
POOL SIZE COMPARISON STUDY

HUITT-ZOLIARS
ADVANCEDDESIGNSM
 MARCH 18 2021

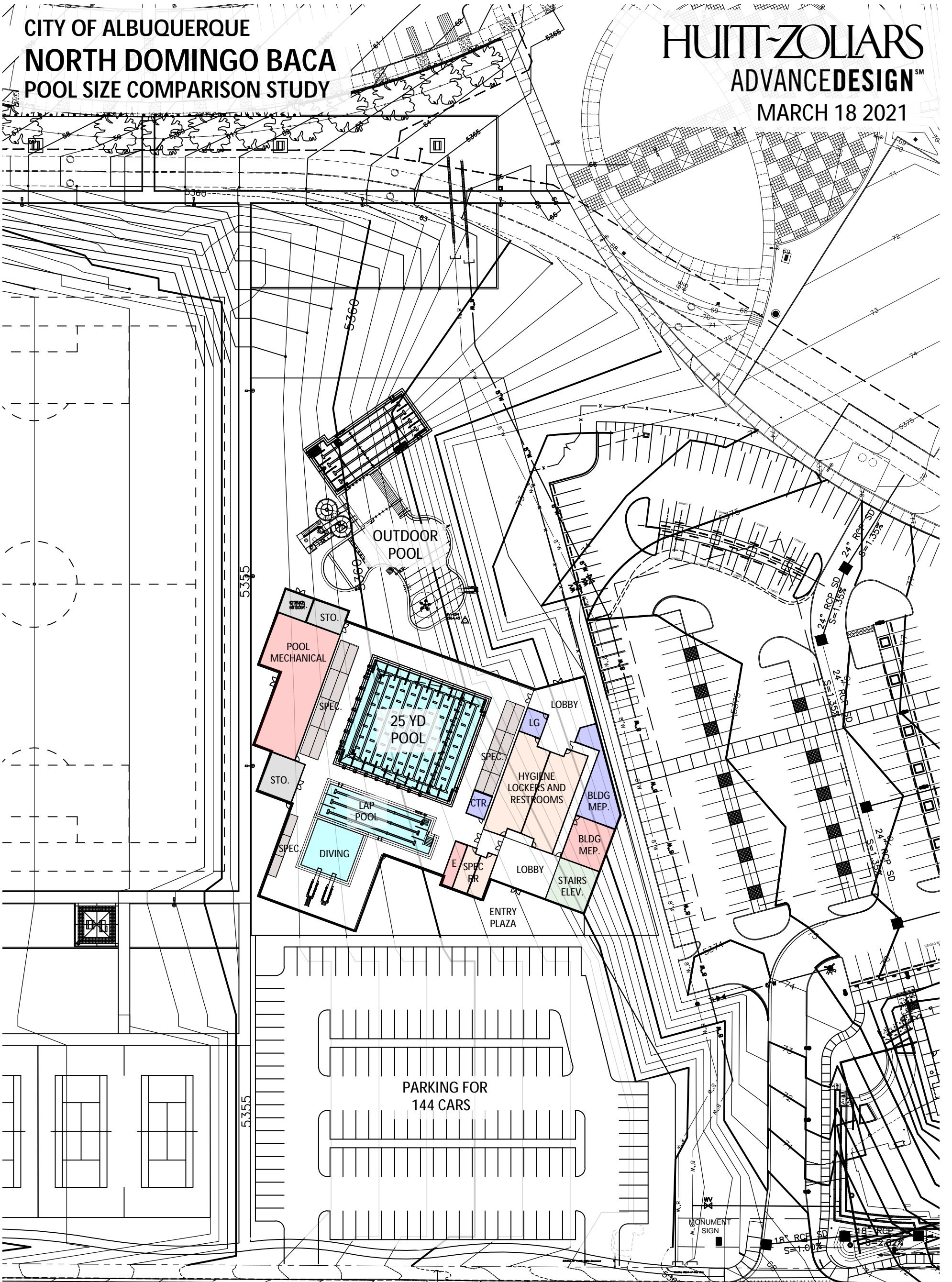

25 YARD POOL
FIRST FLOOR
 1/64" = 1-0"



Spot Elev. Survey Monitors
 Rm Elev. = 5359.89
 Inv Elev. = 5347.14 (1)
 Inv Elev. = 5347.08 (10)
 Inv Elev. = 5348.99 (10)

MEL AVE.

CITY OF ALBUQUERQUE
NORTH DOMINGO BACA
POOL SIZE COMPARISON STUDY

HUITT-ZOLIARS
ADVANCED DESIGNSM
MARCH 18 2021

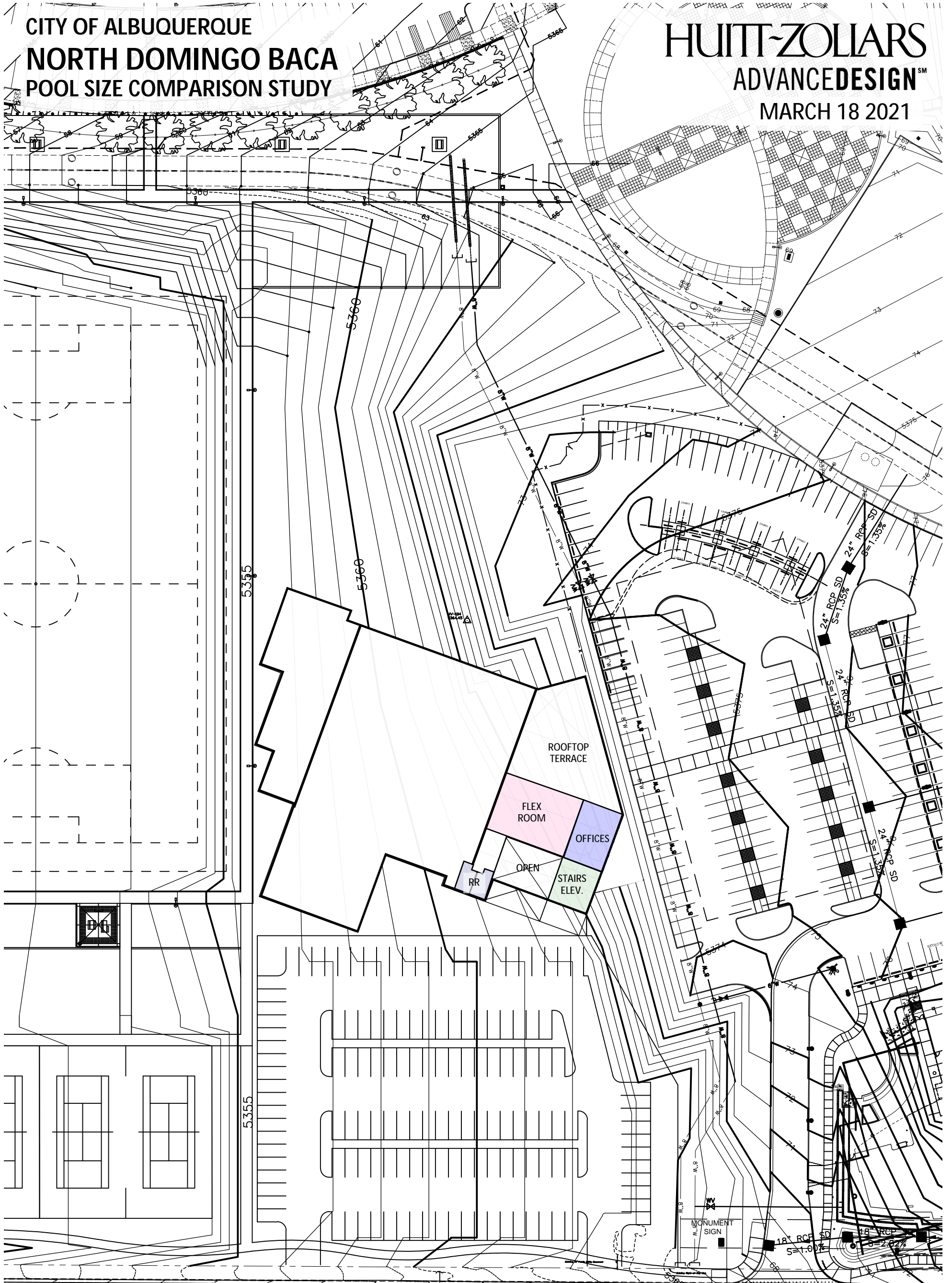

25 YARD POOL
SECOND FLOOR
1/64" = 1-0"

NORTH

Spot Elev. Survey Monuments
Rm Elev. = 5358.89
Inv. Elev. = 5347.14 (1)
Inv. Elev. = 5347.08 (10)
Inv. Elev. = 5348.89 (10)

CITY OF ALBUQUERQUE
 NORTH DOMINGO BACA
 POOL SIZE COMPARISON STUDY

HUITT-ZOLIARS
 ADVANCED DESIGNSM
 MARCH 18 2021

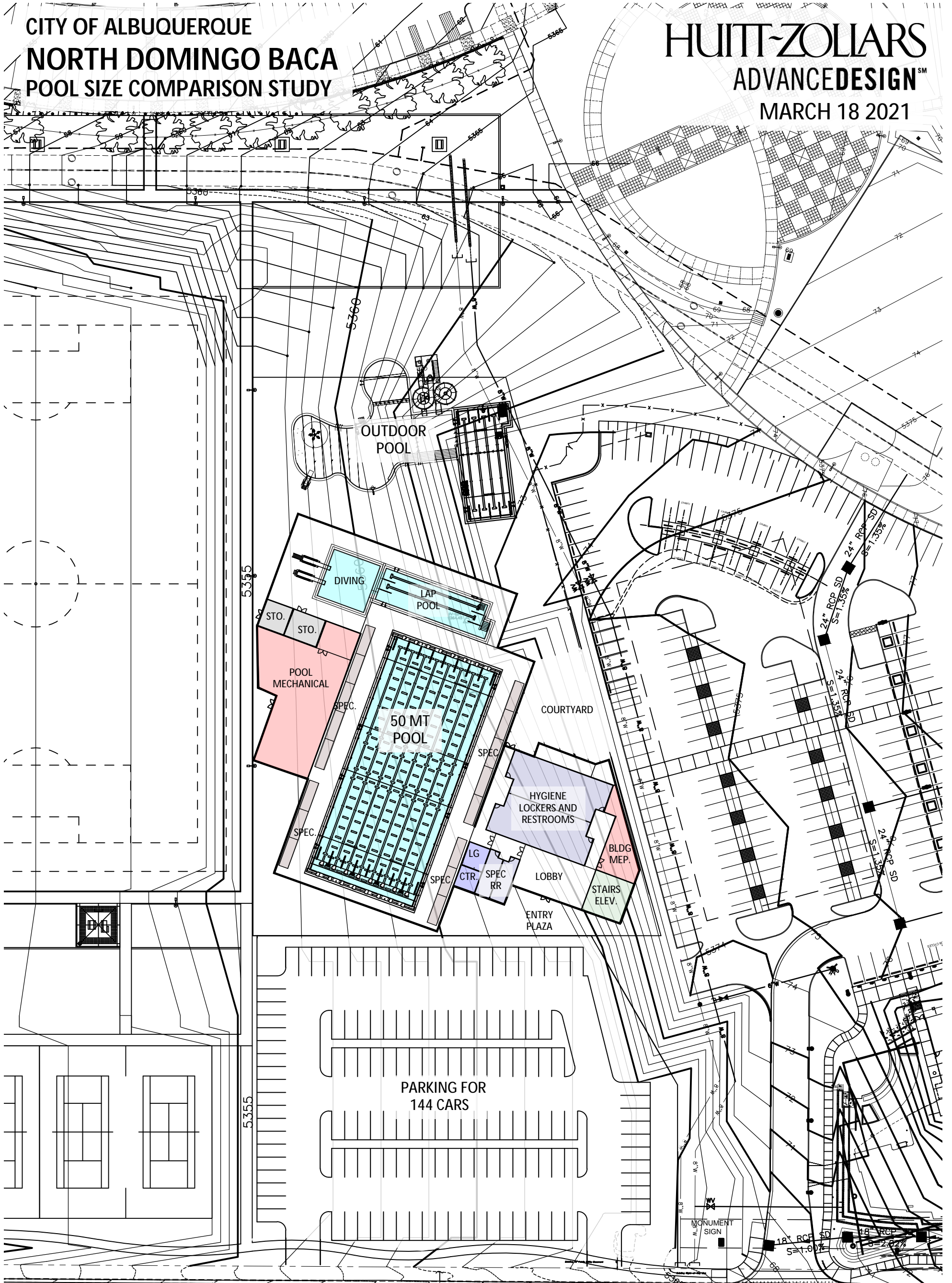

50 METER POOL
 FIRST FLOOR
 1/64" = 1'-0"

NORTH

Spot Elev. - Sinter Membrane
 Rm Elev. = 5358.89
 Inv. Elev. = 5347.14 (E)
 Inv. Elev. = 5347.08 (W)
 Inv. Elev. = 5348.99 (W)

CITY OF ALBUQUERQUE
NORTH DOMINGO BACA
POOL SIZE COMPARISON STUDY

HUITT-ZOLIARS
ADVANCED DESIGNSM
MARCH 18 2021

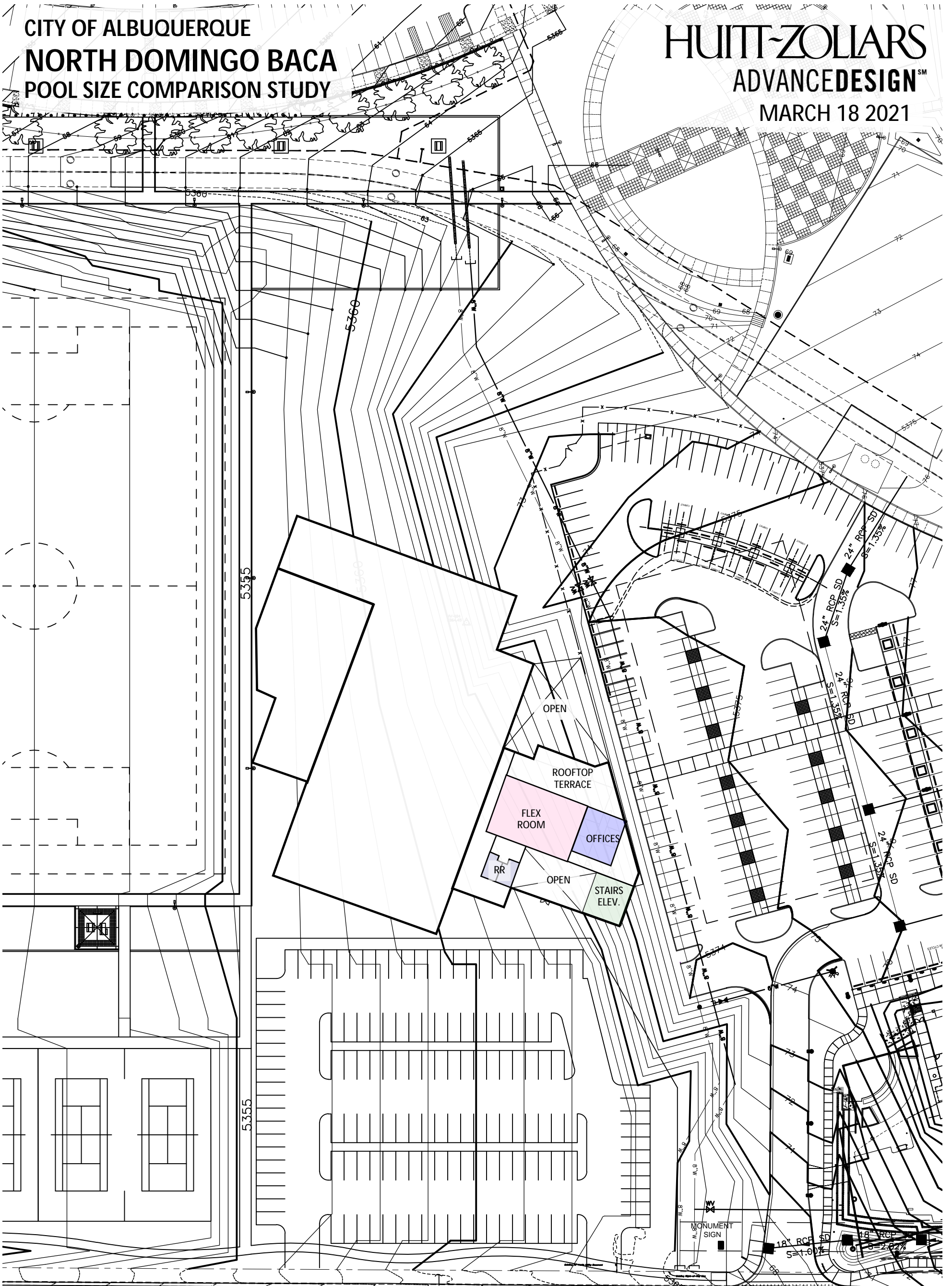

MEL AVE.

50 METER POOL
SECOND FLOOR
1/64" = 1-0"

NORTH

Spot Elev. Survey Monitors
RM Elev. = 5358.89
RM Elev. = 5371.14 (1)
RM Elev. = 5347.08 (10)
RM Elev. = 5348.89 (10)